

Products

by Leland Stone

Clipped Corners

Framing a corner typically requires a third stud that's used as blocking. Along with the need for extra lumber, you also get a cold corner, moisture problems, and corner cracks thrown in at no extra charge.

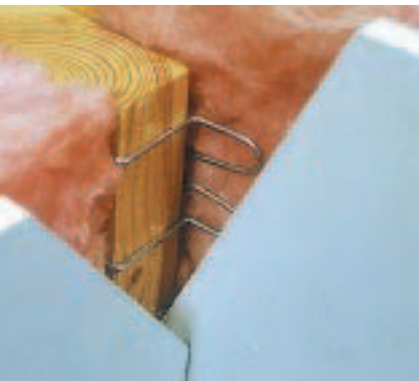

To avoid these problems, check out *R-Plus Warm Corner Framing Clips*. These galvanized steel clips, attached to corner studs or top plates at 16 inches on-center, create a backing for drywall panels. They're installed by hand, and don't need any fasteners, since the second corner panel wedges the first panel against the clips. In fact, corners constructed this

way "float," isolating the wall panels from frame movement. The clips run about \$57 for a box of 500 — enough clips for an average 2,000-square-foot home.

Contact: Stud Claw/U.S.A., 5370 Chestnut Ridge Rd., Orchard Park, NY 14127-3298; 716/662-7877.

Hot Water Circulator

The answer to long waits for hot water at the tap is usually either a point-of-use water heater or a recirculating pump mounted in a separate loop. A new option called the *Metlund D'Mand System* eliminates the need for extra piping by shunting the cooled standing water back through the cold water supply line. The standard kit can be attached to a faucet or shower up to 75 feet away from the hot water heater, and is equipped with a manual start switch that can be configured to activate with the flow of



water or by means of a temperature sensor (faucets in between can be equipped with an optional remote wireless switch). In either case, the pump shuts down automatically when the temperature of the water flowing through it rises by 2°F, signaling that the cool standing column of water has been replaced by a fresh supply of hot water. The D'Mand kit is available through wholesalers as well as directly from the manufacturer; prices start at around \$305.

Contact: Advanced Conservation Technology Inc., 1400 Bristol St. North, Suite 145, Newport Beach, CA 92660; 800/638-5863.

Good Bond

A new vinyl urethane adhesive product can be used with all-thread rod, rebar, and similar hardware. Like any two-part system, *HVU* components must be mixed thoroughly; if you're using these capsules to set rebar dowels, you can shear the end of the dowel at a 45-degree angle, chuck it in your roto-hammer, and go to town (for rebar larger than your drill's chuck capacity, the manufacturer also sells an adapter chuck). HVUs have a high aggregate content, so the mixture won't easily run out of holes, and the adhesive can be installed even in freezing temperatures. HVU capsules are available in sizes from 3/8 inch to 1 1/4 inches in diameter, and the manufacturer will sell direct. List price on a pack of five 5/8-inch HVUs is \$40.25.



Contact: Hilti, Inc., 5400 S. 122nd East Ave., Tulsa, OK 74146; 800/879-8000.

Nifty Miter Box

For small jobs, you might consider replacing your power miter saw with the *J.D. Miter Box*. This manually operated miter box has two fences that adjust independently of each other, and they're covered in a nonslip material. Both fences are equipped with clamps to hold crown molding in position. You've still got to cut the crown "upside down," but the open design of the saw allows you to make cuts from the back of the miter box as well as the front.

The most unusual feature of this saw is its guide, which consists of a pair of magnetized steel posts that grip the saw during the entire cut.

Contact: Rydal Creek Co., P.O. Box 852, Moorestown, NJ 08057; 888/289-7395.

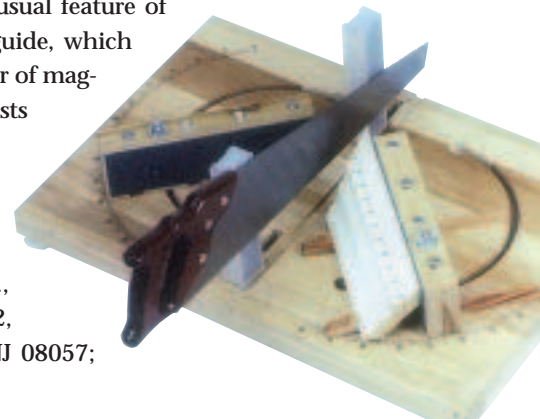

New Composite Siding

Engineered wood siding has taken a beating, both on the job and in the marketplace over the last few years. But the high-profile failure of several products has had one positive effect: Manufacturers have gone back to the drawing board.



Smart Lap is a new composite lap siding made of specially shaped wood chips that are chemically united with a polyurethane binder. This engineered board is reportedly more dimensionally stable than a piece of solid wood siding. *Smart Lap* is also impreg-

nated with powdered zinc borate as a treatment against fungal decay and wood-destroying insects. The factory-primed boards are embossed with a wood-grain surface, and the drip-edges are triple coated against moisture. The transferable warranty on this siding covers 100% of its repair/replacement cost for five years, and a prorated share of the product replacement cost for an additional 20 years. Sold in bundles of five pieces, the 6- or 8-inch-wide boards are 16 feet long and starts at around 70¢ per square foot.

Contact: Louisiana-Pacific, 111 S.W. Fifth Ave., Portland, OR 97204; 800/648-6893.

Tape Trick

Now there's a joint tape that will help part-time drywall tapers look like pros. *UltraFlex* is a prefinished, laminated joint tape made from two layers of paper and one layer of plastic. It is primarily intended as a replacement for steel bead on outside corners (when it's folded, *UltraFlex* is more rigid than steel corner bead). It readily adapts to off angles, and when accidentally struck by furniture or a vacuum cleaner in the completed room, it won't shed flakes of dried joint compound.

The real reason for using *UltraFlex* is to get the job done faster: Corner joints are usually ready to finish on the same day they're taped (although the tape edges may "telegraph" through wet finishing materials). The manufacturer recommends using thinned, all-purpose joint compound, applying it more generously than you'd normally spread on a corner. With a 6-inch taping knife, squeeze the excess mud out from under the tape, and use it to feather the tape edges into the wall. A 100-foot roll of *UltraFlex* will cost you about \$45.

Contact: No Coat, 1320 W. Elliot Rd., Suite 103-466, Tempe, AZ 85284; 888/662-6281.

