

Products

by Dave Crosby

Hollow-Wall Fastener for Steel

Designed to work with steel tubing, where only one side of the structure is accessible, the *Hollo-Bolt* offers high shear and tensile load capabilities in $\frac{5}{16}$ -, $\frac{3}{8}$ -, $\frac{1}{2}$ -, and $\frac{3}{4}$ -inch sizes. If needed, threaded rod can be substituted for the Grade 5 bolt. Prices range from \$4.03 to \$12.85 each.

Contact: Lindapter, 3924 Varsity Dr., Ann Arbor, MI 48108; 888/724-2323; www.lindapter.com.



Deck Retrofit

This maintenance-free vinyl deck board installs over existing wood or concrete surfaces, so there are no tear-up or disposal costs. Air channels underneath the *Durable Deck* allow moisture to evaporate from the original decking, and vinyl strips provide a watertight seal and a quiet walking surface. The $5\frac{1}{2}$ -inch-wide slip-resistant material is available in six colors in lengths of 12, 16, or 20 feet for \$1.49 per linear foot.

Contact: Anchor Decking Systems, 1101 NW 31st Ave., Pompano Beach, FL 33069; 888/898-4990.



Outdoor Vinyl Flooring

This chemical-resistant, fabric-reinforced vinyl membrane provides a durable nonskid, fire-resistant, waterproof surface for many outdoor or indoor applications, including roof and pool decks, garages, balconies, gym and equipment rooms, and wheel-chair ramps. *Duradek* comes in a variety of colors, patterns, and textures, and requires no regular maintenance beyond cleaning. The material can be applied over nearly any solid subsurface, and installs quickly in nearly any weather conditions. Minimal prep work is required because the membrane moves independently, bridging small cracks and expanding and contracting with the substrate. The material can be walked on even during installation, which is performed by trained subcontractors for between \$5 and \$8.50 per square foot.



Contact: Ensuro Duradek, 1720 Iron St., Kansas City, MO 64116; 800/338-3568; www.duradek.com.

Truck Bed

If your pickup bed just isn't enough truck, consider remodeling it with the *Redi-Dek* steel platform body. Available in 8-, 9-, 10-, and 12-foot lengths, the $85\frac{5}{8}$ -inch or $95\frac{5}{8}$ -inch-wide body has outside 2x4 stake pockets, $\frac{1}{4}$ x2-inch tiedown rails, and a $\frac{1}{8}$ -inch steel plate floor immersion-primed for rust resistance. A slotted bulkhead protects the cab, and cutouts are provided for lights. Available through distributors, prices vary.

Contact: Reading Body Works, P.O. Box 650, Shillington, PA 19607; 800/458-2226; www.readingbody.com.



Metal Roof Panels

This 26-gauge zinc-aluminum coated steel panel is designed to look like red tile, but it only weighs 1 $\frac{1}{4}$ pounds per square foot. *Spanish Red Tile* roof panels are part of a line of metal roofing products that features easy installation and 230-mph wind resistance. Available in 3-foot widths and standard lengths of 2 to 20 feet, along with custom-sheared lengths, average cost is about \$170 to \$200 per square, not including labor.

Contact: Met-Tile, P.O. Box 4268,
Ontario, CA 91761; 800/899-0311;
www.met-tile.com.



Wide Decking

With the same loadbearing capacity as 6-inch deck boards, this 12-inch-wide PVC deck board can be ripped or custom cut around posts without sacrificing strength. The wider *Sheerline PVC Decking System* is also useful for outdoor stairs and steps because only one board per tread is needed. The UV-stabilized, high-impact, one-piece profile is said to be squeak-free, 50% stronger than two-piece systems, and more durable than wood. Available in beige, white, or gray, this maintenance-free material features a slip-resistant surface, and comes with all finishing parts needed for about \$4.60 per square foot.

Contact: L.B. Plastics, P.O. Box 907, Mooresville, NC 28115;
800/752-7739.

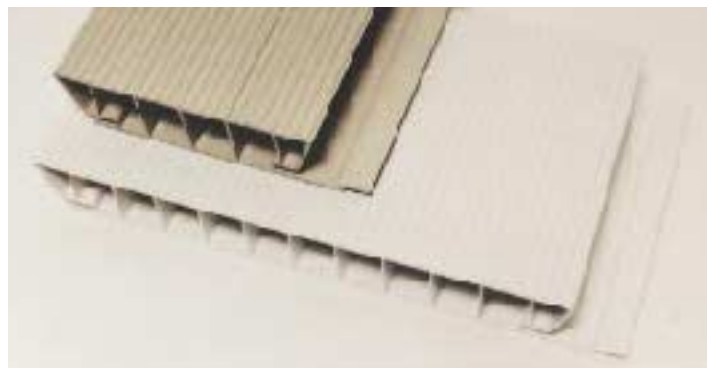

Durable Hydronic Baseboard

Looking for a more durable alternative to conventional hydronic baseboard? The *UF-2* baseboard unit uses 20-gauge welded-steel panels instead of fintubes with steel covers, so the entire unit conducts heat from the hot water. Finished with a factory-applied acrylic enamel, the 6-inch-



high model has an output of 600 Btuh per ft. at 180°F. The list price for the UF-2 is about \$45 a foot; other sizes are available.

Contact: Runtal Radiators, P.O. Box 8278,
Ward Hill, MA 01835; 800/526-2621;
www.runtalnorthamerica.com.

Outdoor Accent Lighting

These miniature 12-volt accent lights can be used on decks, steps, or anywhere an inconspicuous light source is needed. The *P5223-31WB* and the *P5224-31WB* under-rail lights feature powder-coated aluminum housings for resistance to chipping, fading, and the effects of salt air. Suggested retail is \$45.

Contact: Progress Lighting, P.O. Box 5704,
Spartanburg, SC 29304; 864/599-6000;
www.progresslighting.com.

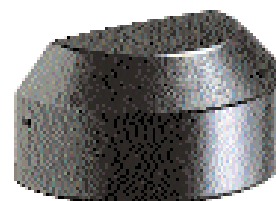
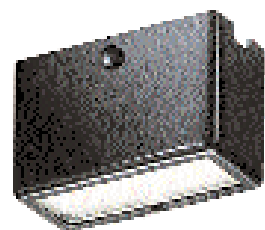

Rooftop Snow Fence

Snow that slides suddenly off a roof (especially a metal roof) can pull off metal chimneys or crush the railings on a deck below. One solution is the installation of aluminum pipe-style *Alpine SnowGuards* at the eaves. A variety of brackets are available for metal, slate, and membrane roofs. Material costs are \$10 to \$14 per foot.

Contact: Alpine SnowGuards, P.O.
Box 430, Stowe, VT 05672; 888/766-4273;
www.alpinesnowguards.com

