

Products

Drainage Panel. Properly flashing the bottom of a masonry cavity wall usually requires separate components, but Mortar Net's *TotalFlash Cavity Wall Drainage System* combines everything — flexible flashing, a stainless steel drip edge, and nonclogging drainage mesh — in one precut, preassembled panel. The product comes in overlapping 5½-foot-long pieces with sealant and screws and costs about \$9.75 per linear foot of coverage.

Mortar Net, 800/664-6638, mortarnet.com.

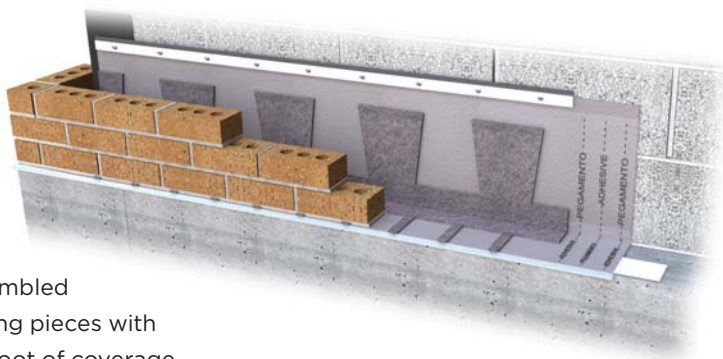

Spray-On. Icynene's water-blown *LD-R-50 Spray Foam Insulation* expands to 100 times its applied thickness to completely fill wall and rafter cavities. It does double-duty as a built-in air barrier, and the open-cell foam is water-vapor-permeable. This new formula uses a castor-bean oil ingredient to reduce its petroleum-based content and has an R-value of 3.7 per inch. Installation by a licensed dealer costs 65 cents per inch thickness per square foot.

Icynene, 800/758-7325, icynene.com.

Shower Seat. Built-in shower seat structures can be a challenge to make, install, and waterproof — there's always the worry that water will get beneath the tile and compromise the wooden frame. ProSpec's *PreFormed Shower Seats* are made of waterproof high-density foam and install with thinset mortar to avoid any fastener penetrations through the shower wall. A 22¾-inch-wide triangular seat costs \$135. Other sizes and preformed wall niches are also available.

ProSpec, 800/738-1621, prospec.com.



Products

Three-Way Flashing. Faulty flashing installation can lead to water damage and mold, not to mention expensive callbacks. OSI's solution is the *Winteq Window Installation System*, which comes complete with sealant for the window flange, rubberized asphalt flashing tape,



and low-expansion closed-cell foam. All three components are chemically compatible — not always the case when you're mixing products from different manufacturers, according to OSI. Flashing a 3-foot-by-5-foot window with the product costs about \$12.70.

OSI, 800/321-3578, osisealants.com.



Skip the Crane. *LiteSteel Beams* offer the strength of steel at 40 percent less weight than standard steel I-beams or engineered wood beams, according to the maker. They're also easy to saw on site and can be nailed into with a standard framing gun, says the company, which provides software on its Web site to help with sizing. An 18-foot long, 8-inch-tall garage-door header weighs 107 pounds and lists for \$160.

LiteSteel Technologies, 877/285-2607, litesteelbeam.com.



Green Drive. Not everyone wants a big expanse of asphalt or concrete dominating their landscape. *Drivable Grass Mats* by Soil Retention Systems provide better drainage and hold less summer heat than paved drives while looking a lot greener. The 2-foot squares can also be used for drainage erosion control. They're made of 4,000-psi concrete for heavy load capacity, come in three colors, and cost \$2.50 each.

Soil Retention Systems, 800/346-7995, soilretention.com

Push Fit. Plumbing supply lines keeps getting easier with products like *Sharkbite Push-Fit Fittings* by Cash Acme. With no solder or cement needed, these fittings make permanent connections in copper, PEX, and CPVC tubing, and they're UPC- and IPC-approved for installation behind walls without access panels, says the maker. Unlike traditional fittings, they can be twisted into position while under pressure and can be easily removed and refitted. A 1/2-inch coupling costs \$5.35.

Cash Acme, 877/700-4242, sharkbite.com.

